

# OFFICIAL ZONING MAP

## City of Andale

### Sedgwick County, Kansas

### Zoning Districts

-  R-1 Single-Family Residential District
-  R-2 Multiple-Family Residential District
-  B-1 Central Business District
-  B-2 General Business District
-  I-1 Industrial District

OFFICIAL COPY OF ZONING DISTRICT MAP  
 INCORPORATED INTO ZONING REGULATIONS  
 BY ADOPTION OF ORDINANCE NUMBER 09-06  
 BY THE GOVERNING BODY OF THE CITY OF ANDALE  
 ON THE 27TH DAY OF JULY, 2009.

EFFECTIVE DATE: JULY 30, 2009

MAYOR: Gerard N. Martin

ATTEST: CITY CLERK — Virginia Edwards

REVISION DATE:  
 • October 1, 2009

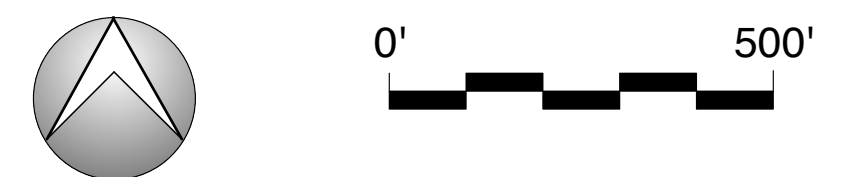
  
 PLOTTED SCALE 1"=250'

ORIGINAL CITY BASE MAP:  
 E.B.H. AND ASSOCIATES  
 (EVANS – BIERLY – HUTCHISON & ASSOCIATES, P.A.),  
 ENGINEERS, PLANNERS & SURVEYORS –  
 GREAT BEND, KANSAS.

ZONING INFORMATION:  
 RICE FOSTER ASSOCIATES, P.A.,  
 LANDSCAPE ARCHITECTS PLANNERS,  
 WICHITA, KANSAS –  
 OCTOBER 2009.

LANDSCAPE ARCHITECTS PLANNERS **rice-foster** associates

1415 East 2nd Street phone 316-262-4525  
 Wichita, KS 67214 fax 316-262-7316  
 project 09036 www.ricefoster.com

 **FOSTER & ASSOCIATES**  
 PLANNING CONSULTANTS  
 WICHITA, KANSAS

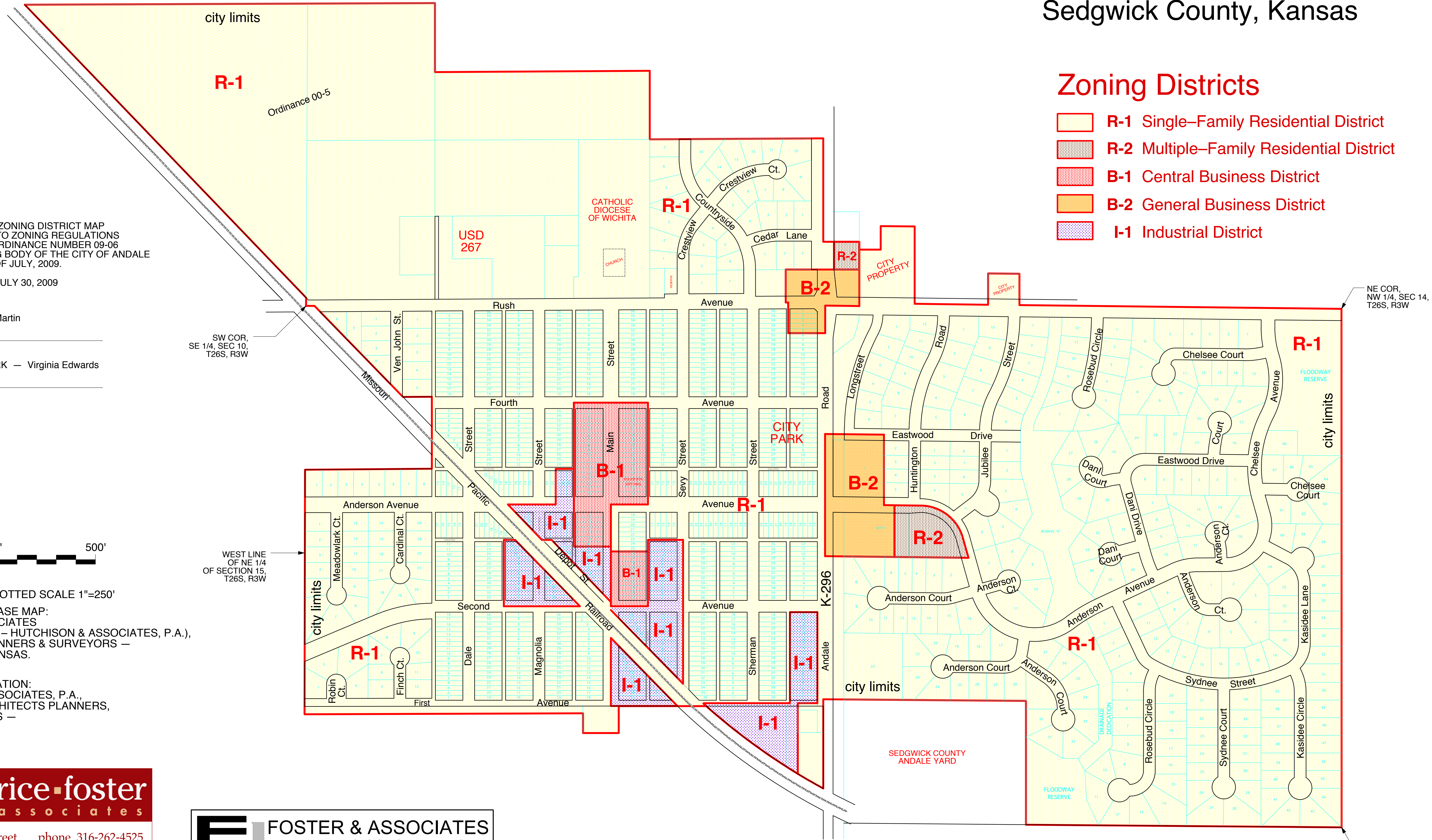

SW COR,  
 SE 1/4, SEC 10,  
 T26S, R3W

WEST LINE  
 OF NE 1/4  
 OF SECTION 15,  
 T26S, R3W

NE COR,  
 NW 1/4, SEC 14,  
 T26S, R3W

SE COR,  
 NW 1/4, SEC 14,  
 T26S, R3W